

Self-lubricating Bronze Plain Washers-SPW

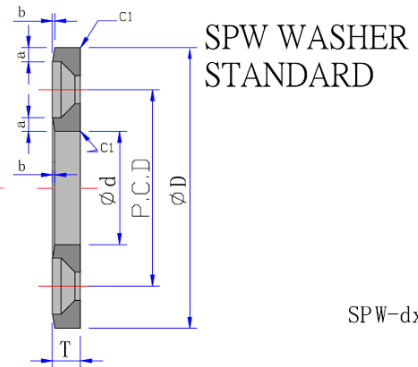
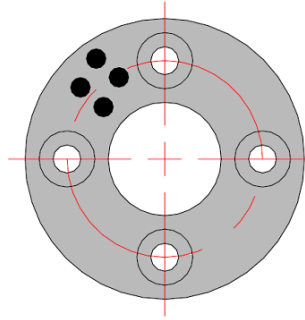
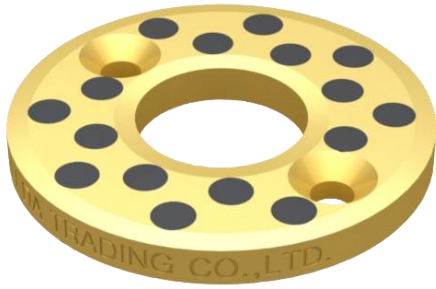

SPW-dxT

Standard No.			Screw Holes			Chamfers	
Ød	ØD	$T_{-0.1}^0$	P.C.D.W	Number of Holes	Flat Head Screw	a	b
10.2	30	3	20	2	M3	2	0.3
12.2	40	3	28	2	M3	2	0.4
13.2	40	3	28	2	M3	2	0.4
14.2	40	3	28	2	M3	2	0.4
15.2	50	3	35	2	M3	2	0.4
16.2	50	3	35	2	M3	2	0.4
18.2	50	3	35	2	M3	2	0.4
20.2	50	5	35	2	M5	2.5	0.4
25.2	55	5	40	2	M5	2.5	0.4
30.2	60	5	45	2	M5	2.5	0.4
35.2	70	5	50	2	M5	2.5	0.4
40.2	80	7	60	2	M6	3	0.5
45.2	90	7	70	2	M6	3	0.5
50.3	100	8	75	4	M6	4	0.6
55.3	110	8	85	4	M6	4	0.6
60.3	120	8	90	4	M8	5	0.8
65.3	125	8	95	4	M8	5	0.8
70.3	130	10	100	4	M8	5	0.8
75.3	140	10	110	4	M8	5	0.8
80.3	150	10	120	4	M8	5	0.8
90.5	170	10	140	4	M10	5	0.8
100.5	190	10	160	4	M10	5	0.8
120.5	200	10	175	4	M10	5	0.8
12.2	40	3	28	2	Without flat head screw hold	2	0.8
16.2	50	3	35	2	Without flat head screw hold	2	0.8