

# 塑料滑动轴承-EP

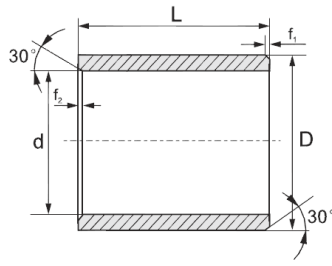

推荐安装公差

座孔: H7

轴: h9

订货型号:

EP3-0608-06

d D L

材料

d	f <sub>1</sub>	f <sub>2</sub>
d ≤ 10	0.5	0.5
10 < d ≤ 30	0.8	0.5
30 < d	1.2	0.5

规格	d(After fitting)	D	L(h13)	规格	d(After fitting)	D	L(h13)
EP-0304-03			3	EP-2225-20			20
EP-0304-05	3 <sup>+0.054</sup> <sub>+0.014</sub>	4.5	5	EP-2225-25	22 <sup>+0.124</sup> <sub>+0.040</sub>	25	25
EP-0304-06			6	EP-2225-30			30
EP-0405-04	4 <sup>+0.068</sup> <sub>+0.020</sub>	5.5	4	EP-2528-12			12
EP-0405-06			6	EP-2528-15			15
EP-0507-05			5	EP-2528-20	25 <sup>+0.124</sup> <sub>+0.040</sub>	28	20
EP-0507-08	5 <sup>+0.068</sup> <sub>+0.020</sub>	7	8	EP-2528-25			25
EP-0507-10			10	EP-2528-30			30
EP-0608-06			6	EP-2832-20			20
EP-0608-08	6 <sup>+0.068</sup> <sub>+0.020</sub>	8	8	EP-2832-25	28 <sup>+0.124</sup> <sub>+0.040</sub>	32	25
EP-0608-10			10	EP-2832-30			30
EP-0810-06			6	EP-3034-20			20
EP-0810-08			8	EP-3034-25			25
EP-0810-10	8 <sup>+0.083</sup> <sub>+0.025</sub>	10	10	EP-3034-30	30 <sup>+0.124</sup> <sub>+0.040</sub>	34	30
EP-0810-12			12	EP-3034-40			40
EP-0810-15			15	EP-3236-20			20
EP-1012-04			4	EP-3236-30		36	30
EP-1012-06			6	EP-3236-40			40
EP-1012-08			8	EP-3539-20			20
EP-1012-10			10	EP-3539-25			25
EP-1012-12	10 <sup>+0.083</sup> <sub>+0.025</sub>	12	12	EP-3539-30	35 <sup>+0.150</sup> <sub>+0.050</sub>	39	30
EP-1012-15			15	EP-3539-40			40
EP-1012-18			18	EP-3539-50			50
EP-1012-20			20	EP-4044-20			20
EP-1214-06			6	EP-4044-30	40 <sup>+0.150</sup> <sub>+0.050</sub>	44	30
EP-1214-08			8	EP-4044-40			40
EP-1214-10			10	EP-4044-50			50
EP-1214-12	12 <sup>+0.102</sup> <sub>+0.032</sub>	14	12	EP-4550-30	45 <sup>+0.150</sup> <sub>+0.050</sub>	50	30
EP-1214-15			15	EP-4550-50			50
EP-1214-20			20	EP-5055-20			20
EP-1214-25			25	EP-5055-30	50 <sup>+0.150</sup> <sub>+0.050</sub>	55	30
EP-1416-15			15	EP-5055-40			40
EP-1416-20	14 <sup>+0.102</sup> <sub>+0.032</sub>	16	20	EP-5055-50			50
EP-1416-25			25	EP-5560-40	55 <sup>+0.180</sup> <sub>+0.060</sub>	60	40
EP-1517-10			10	EP-5560-60			60
EP-1517-15			15	EP-6065-40	60 <sup>+0.180</sup> <sub>+0.060</sub>	65	40
EP-1517-20	15 <sup>+0.102</sup> <sub>+0.032</sub>	17	20	EP-6065-50			50
EP-1517-25			25	EP-6570-50	65 <sup>+0.180</sup> <sub>+0.060</sub>	70	50
EP-1618-12			12	EP-7075-60	70 <sup>+0.180</sup> <sub>+0.060</sub>	75	
EP-1618-15			15	EP-7580-60	75 <sup>+0.180</sup> <sub>+0.060</sub>	80	60
EP-1618-20	16 <sup>+0.102</sup> <sub>+0.032</sub>	18	20	EP-8085-100	80 <sup>+0.180</sup> <sub>+0.060</sub>	85	
EP-1618-25			25	EP-8590-100	85 <sup>+0.212</sup> <sub>+0.072</sub>	90	
EP-1820-15			15	EP-9095-100	90 <sup>+0.212</sup> <sub>+0.072</sub>	95	
EP-1820-20	18 <sup>+0.102</sup> <sub>+0.032</sub>	20	20	EP-95100-100	95 <sup>+0.212</sup> <sub>+0.072</sub>	100	
EP-1820-25			25	EP-100105-100	100 <sup>+0.212</sup> <sub>+0.072</sub>	105	
EP-2023-15			15	EP-110115-100	110 <sup>+0.212</sup> <sub>+0.072</sub>	115	100
EP-2023-20			20	EP-120125-100	120 <sup>+0.212</sup> <sub>+0.072</sub>	125	
EP-2023-23	20 <sup>+0.124</sup> <sub>+0.040</sub>	23	23	EP-125130-100	125 <sup>+0.245</sup> <sub>+0.085</sub>	130	
EP-2023-25			25	EP-130135-100	130 <sup>+0.245</sup> <sub>+0.085</sub>	135	
EP-2023-30			30	EP-140145-100	140 <sup>+0.245</sup> <sub>+0.085</sub>	145	
EP-2225-15	22 <sup>+0.124</sup> <sub>+0.040</sub>	225	15	EP-150155-100	150 <sup>+0.245</sup> <sub>+0.085</sub>	155	