

Linear Bearing-LM

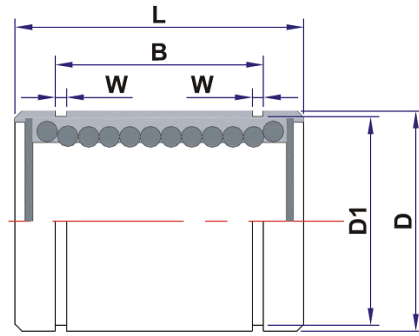
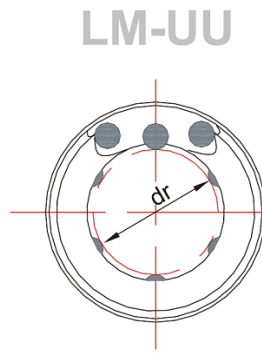

Main Dimensions														Basic load rating										
Model No.	Number of ball rows	Weight		Inscribed circle diameter		Outer diameter		Length		Outer locking groove		W	Eccentricity (max.)	Radial clearance (max μ m)	Dynamic C(kgf)	Static Co(kgf)								
		g	dr	Tolerance	D	Tolerance	L	Tolerance	B	Tolerance	D1													
LM 3	4	1.4	3	0	7	0	10	0	-0.12	10.2	9.6	1.1	0.008	-3	7	11								
LM 4		2.0	4		8		12																	
LM 5		4.0	5		10		15																	
LM 6		8.5	6		12		19								13.5	11.5								
LM8S		11	8		15		17										11.5	14.3						
LM 8		17	8		15		24								17.5	14.3								
LM10		32	10		19		29								0	22	18	0.012	-4					
LM12		36	12		21		30								-0.20	23	20			1.3				
LM13		43	13		23		32								-0.013	23	22							
LM16		5	70		16		28								37	26.5	27	1.6	0.015	-6				
LM20	90		20	32	42	30.5	30.5																	
LM25	6	230	25	0	40	0	59	-0.30	-0.30	41	38	1.85	0.015	-8	100	160								
LM30		260	30		45		64								44.5	43								
LM35		400	35		52		70								49.5	49								
LM40		600	40		60		80								60.5	57	0.020	-10						
LM50		1600	50		80		100								74	76.5			2.6					
LM60		2000	60		90		110								85	86.5	3.15	0.025	-13					
LM80		4500	80		120		-0.022								140	0	-0.40			105.5	0	116	4.15	-20