

樹脂直線軸承-LIN-11K 滑動膜

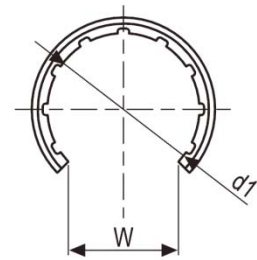
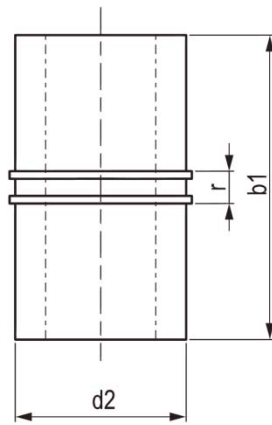

型號	d1 mm	公差 mm	d2 mm	b1 mm	W+0.2 mm	r(-0.1/-0.2) mm	重量 g
LIN-11K-10	10	+0.030 ~ -0.070	12	29	7.3	3.0	1.0
LIN-11K-12	12	+0.030 ~ -0.070	14	31	9.0	3.0	1.3
LIN-11K-16	16	+0.030 ~ -0.070	18	35	11.6	3.5	1.9
LIN-11K-20	20	+0.030 ~ -0.070	23	44	12.0	5.0	4.5
LIN-11K-25	25	+0.030 ~ -0.070	28	57	14.5	5.0	7.5
LIN-11K-30	30	+0.040 ~ -0.085	34	67	16.6	5.0	14.5
LIN-11K-40	40	+0.040 ~ -0.085	44	79	21.0	6.0	24.5
LIN-11K-50	50	+0.050 ~ -0.100	55	99	25.5	7.0	49.0

裝配尺寸

型號	d1 mm	D H7 mm	B h10 mm	W mm	r mm	z mm
LIN-11K-10	10	12	29	7.3	3.0	2.3
LIN-11K-12	12	14	32	9.0	3.0	3.1
LIN-11K-16	16	18	36	11.6	3.5	3.6
LIN-11K-20	20	23	45	12.0	5.0	3.6
LIN-11K-25	25	28	58	14.5	5.0	4.1
LIN-11K-30	30	34	68	16.6	5.0	4.1
LIN-11K-40	40	44	80	21.0	6.0	5.1
LIN-11K-50	50	55	100	25.5	7.0	6.1

